

Medical Center Campus

950 N.W. 20 Street
Miami, FL 33127-4622



Classroom Location(s)

- Please refer to classroom number in your schedule

Parking Information

Students can park in the student parking lot, located to the west of the main campus building. Please note that a valid student decal is necessary.

Faculty can park in the faculty & staff parking lot, located on NW 21 street, to the north of the main campus building. Also note that a valid decal is required.

Health Sciences & Related Studies Department

950 N.W 20th Street
Suite 2306
Building #2, 3rd Floor.
Miami, FL 33127
Telephone: (305)237-4296
Fax: (305)237-4154.

FLOOR PLANS

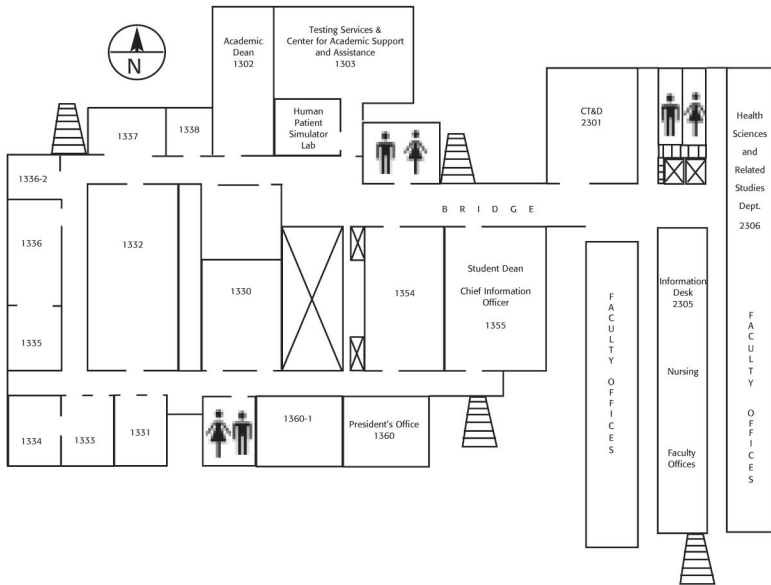

FLOOR PLANS

